

BALANCE CABLE FAIRLEAD  
30X60 (4 REQ'D)  
2 PIECES: ONE RIVETED TO  
6B11-2, THE OTHER TO 6B5-1

3/4" HOLE IN SIDE  
SKIN 6B11-2

4 RIVETS A5

CHECK: 120MM POSITIONS AILERON  
CABLE TO TURNBUCKLE ON TORQUE  
TUBE 6B17-4 PARALLEL TO CROSS  
STIFFENER 6B1-7

6B17-4

120

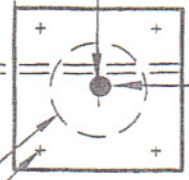

110

6B1-7

2 RIVETS A5

120

6B5-1

FRWD

LOCATION OF AILERON & BALANCE  
CABLE THROUGH FORWARD SIDE  
SKINS 6B11-2

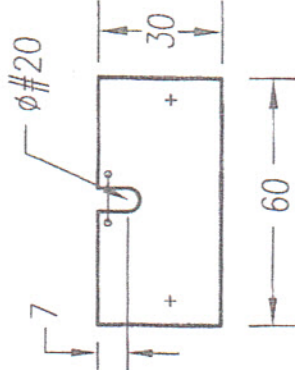
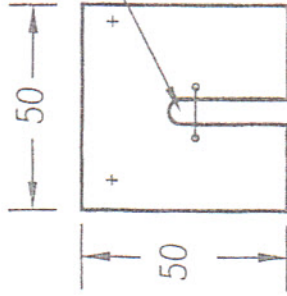
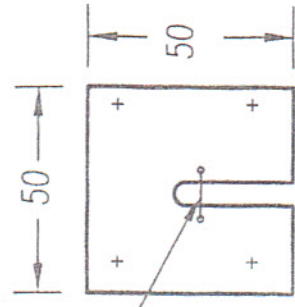

NO HOLE (QTY=2)  
RIVETS TO 6B5-1

**AILERON FAIRLEAD**

NYLON 66 t=1/8" 50X50 (QTY=2)

**MIDDLE BALANCE FAIRLEAD**

NYLON 66 t=1/8" 50X50 (QTY=1)

**BALANCE FAIRLEADS**

NYLON 66 t=1/8" 30X60 (QTY=4)